

# PMC-V

## Human Machine Interface for PMC-D Drive Control Systems



In face conveyor or plow automation systems the HBT PMC-V provides the human machine interface (HMI) to interact with the PMC-D drive controls to operate manual mode, visualize and change parameters and show actual process values. Within a PMC-D system minimum one and typically up to 3 PMC-Vs are in equal operation.

### Main Technical Data

- > 320 × 240 pixel b/w graphics display
- > IP 68
- > Power: 12 W
- > 12 SKK24 sockets for power supply, communication, sensors and actuators
- > Optional additional Profibus communication channel for communication with third party computer

### Electrical Data

| Parameter      | Typical Value | Maximum Ratings |
|----------------|---------------|-----------------|
| Supply Voltage | 12V DC        | 9.5 V – 13.2 V  |
| Supply Current | 1 A           | 1.5 A           |

### Environmental Data

| Parameter   | Symbol           | Typical Value | Maximum Ratings                   |
|-------------|------------------|---------------|-----------------------------------|
| Temperature | T <sub>amb</sub> | 20° C (68° F) | -20° C – +40° C (-4° F – +104° F) |

### Features:

- > Human machine interface for configuration and customization of the PMC-D/V family
- > Diagnostic features for whole system
- > Process visualization
- > Change of parameters
- > Communication link to other systems
- > Additional sensor inputs

### Global Certifications

- > Europe: ATEX
- > U.S.: MSHA
- > Russia: GOST
- > Australia: IECEx, ANZEx
- > China: MA
- > More certifications on demand

# PMC-V Human Machine Interface for PMC-D Drive Control Systems

## Dimensions

All dimensions are approximate.

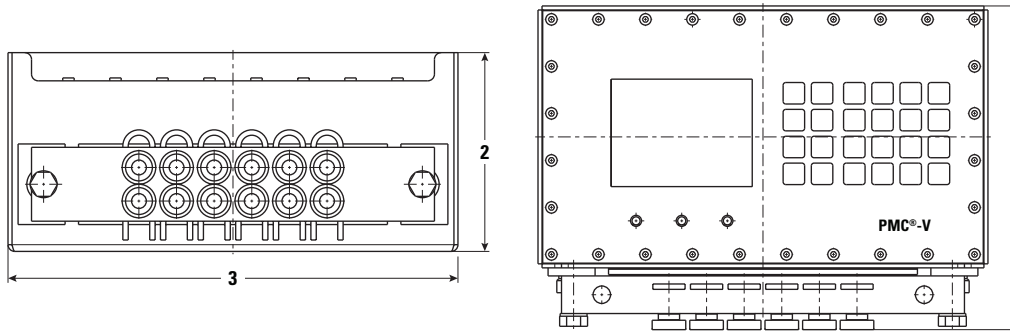

|                 |        |          |
|-----------------|--------|----------|
| <b>1</b> Width  | 241 mm | 9.49 in  |
| <b>2</b> Height | 148 mm | 5.83 in  |
| <b>3</b> Length | 335 mm | 13.19 in |

## Electrical Sockets

| Socket | Pin 1             | Pin 2                  | Pin 3                  | Pin 4               |
|--------|-------------------|------------------------|------------------------|---------------------|
| St1    | Optocoupler Anode | Relay Contact NO: a    | Relay Contact NO: b    | Optocoupler Kathode |
| St2    | +12 V (A)         | Serial Interface: RxD  | Serial Interface: TxD  | GND                 |
| St3    | +12 V (B)         | Serial Interface: RxD  | Serial Interface: TxD  | GND                 |
| St4    | +12 V (C)         | Serial Interface: RxD  | Serial Interface: TxD  | GND                 |
| St5    | Options           | Options                | Options                | Options             |
| St6    |                   | Profibus: a (internal) | Profibus: b (internal) |                     |
| St7    | +12 V Input       | Serial Interface: TxD  | Serial Interface: RxD  | GND Input           |
| St8    | +12 V (B)         | Measurement Input 1    | +8.2 V                 | GND                 |
| St9    | +12 V (C)         | Measurement Input 2    | +8.2 V                 | GND                 |
| St10   | +12 V (A)         | Measurement Input 3    | +8.2 V                 | GND                 |
| St11   | Options           | Options                | Options                | Options             |
| St12   |                   | Profibus: a (internal) | Profibus: b (internal) |                     |

## Options

The designations of the options equal the second and third to last characters of the type designation listed on the equipment.

| Option | Socket | Pin 1 | Pin 2                  | Pin 3                  | Pin 4 |
|--------|--------|-------|------------------------|------------------------|-------|
| **     | St5    |       |                        |                        |       |
|        | St11   |       |                        |                        |       |
| AB     | St5    |       | Profibus: a (external) | Profibus: b (external) |       |
|        | St11   |       | Profibus: a (external) | Profibus: b (external) |       |